

CUSTODIAL STAFFING LEVELS AND ASSESSMENTS

Carol Dufek – Manager of Buildings & Grounds
School District of South Milwaukee

cdufek@sdsd.k12.wi.us

Bill King – Director of Buildings & Grounds
Arrowhead Union High School District

kingb@arrowheadschoools.org

Introduction

Today's Challenges:

- 1. Meeting/establishing acceptable levels of cleanliness**
- 2. Properly staff facilities to meet district expectations**
 - a. Determining appropriate staffing levels**
- 3. Become more efficient and streamlined**

Today's Challenges

**Meeting/establishing
acceptable levels of cleanliness**

Develop your Vision

What is your situation:

Daily or alternate day cleaning

Establish standards with your custodial staff for “the look”

Define the term “the look” for each area

Floors: shiny / matt / yellowed

Carpet: new / stained / worn

Restrooms: spotless / stocked / odor free /

grungy

Classrooms: spotless / acceptable / grungy

Define the term “clean”

Hospital look:

Pristine

Shiny, no Dirty look:

No soil or scuff

marks

Clean or Satin look:

Low gloss, no soil

Not a Priority:

Low gloss, visible

dirt

Custodial Frequency of Cleaning

Determine your level of cleaning per building/per room

CLASSROOMS, RESTROOMS, OFFICES, LOCKER ROOMS, HALLS/STAIRS, ETC...

Daily:

1. Clean glass/mirrors
2. Empty all trash containers/change liners as needed
3. Empty pencil sharpeners
4. Straighten furniture
5. Clean black/white boards and chalk trays (Who cleans them: teachers or custodians?)
6. Restock any paper, soap, hand sanitizing products, etc...
7. Sweep floors (dust mop)
8. Vacuum traffic lanes (some elem. carpets may require daily wall to wall service)
9. Empty female receptacle boxes
10. Sanitize restroom fixtures
11. Mop floors

CLEANING GUIDELINES: Classrooms and Offices, Restrooms/Locker Rooms, Halls/Entrances, Shop Areas

TASKS: Classrooms	DAILY	AS NEEDED
Empty waste baskets	X	
Empty pencil sharpeners	X	
Sweep floors (dust mop)	X	
Vacuum carpets	X	
Close and lock windows	X	
Close and lock doors	X	
Wash chalkboard/whiteboard		X
Spot clean floors (wet mop)		X
Clean and sanitize dispensers	X	
Clean and sanitize sinks/fountains	X	
Spot clean glass	X	
Spot clean walls/door frames		X
Clean/arrange furniture	X	
Change/report burned out lights		X

TASK: Restrooms/Locker Rooms
Empty waste baskets
Empty sanitary napkin receptacles
Clean and sanitize toilets
Clean and sanitize sinks
Clean and sanitize urinals
Clean and sanitize floors (wet mop)
Clean and sanitize dispensers
Clean and sanitize showers
Clean glass/mirrors
Restock paper products
Restock hand soap
Spot clean walls
Spot clean/dust lockers
Spot clean partitions
Change/report burned out lights

TASKS: Halls/Outside Grounds
Empty waste baskets
Sweep floors (dust mop)
Vacuum mats/runners
Clean and sanitize sinks/fountains
Spot clean glass
Scrub floors (auto scrubber)
Spot clean walls/locker fronts
Change/report burned out lights
Clean corners and edges
Burnish floors
EXTERIOR OF BUILDING
Clean entrances
Clean/pick up grounds

Daily = All school days

As Needed = When used and/or requires cleaning
Carpet stains must be removed or reported immediately

GRAFFITI MUST BE REMOVED IMMEDIATELY

Determining Daily or Alternate Day Cleaning

- District Expectations of Custodial / Cleaning Services
 - Hospital look: Pristine
 - Shiny, no Dirty look: No soil or scuff marks
 - Clean or Satin look: Low gloss, no soil
 - Not a Priority: Low gloss, visible dirt
- Budget
 - How much is allocated for custodial/cleaning staff
- Staffing
 - Fully staffed
 - Issues in recruitment
- Building Buy in
 - Teachers helping
 - Day custodial duties

***NOTE that all facilities do not clean the same multi story/floor finishes/correct equipment

Today's Challenges

**Properly staff facilities to meet
district expectations**

(Determining appropriate staffing levels)

Why to Perform Custodial Assessments

Assessments will help you:

- Determining proper custodial staffing levels

- Determine best types of staffing such as

 - Full time, Part time, Full time school year, Part time school year

 - Don't forget...part time can be 4, 5 or 6 hours or any combination thereof

***Important to differentiate between your “**service**” custodians (daytime staff) and your “**production**” custodians (night time staff)

Why, How and Where to start assessments:

Why: Because areas seem unfair,
Someone thinks staffing is wrong,
This process helps support your
staffing needs.



How: You will need **UPDATED** maps of your schools

Where to start: You will need to interview
your staff for current accurate areas.

At this time,
DO NOT DEBATE these times.

Gathering the Data for the Assessment

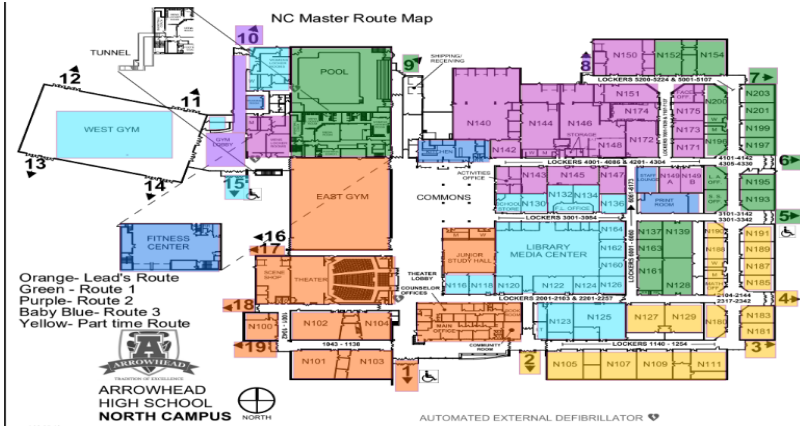

Ask the questions:

Is the route too big or small?

Is the staff member following the map?

Are the expectations being met?

cleanliness?

Are there excessive complaints on

Is there retraining of staff needed?

Does staff have the correct equipment?

Assessment Tools for “Right Sizing” Routes

Time Study

- Actual time it is taking staff to get through their route.
- Equipment Assessment (are all tools being used for efficiency).

Staff Required for Adequate Cleaning Level



Cleanliness Level	Minimum Area *	Maximum Area *
Spotless Cleaning	10,000	11,000
Intensive Cleaning	18,000	20,000
Cleaning to ensure health & comfort for building users	28,000	31,000
Cleaning not generally acceptable for school environments	45,000	50,000
Cleaning considered unhealthy	85,000	90,000

* Measured in square feet

Remember: Primary and secondary building square footage per area will vary due to the needs at each learning level.

**** Primary Levels** will have higher cleaning times than secondary levels.

How to Gather Information for Time Study

Employee Worksheet:

School Name: K-Tec East				Employee: Dale
	Room Number <u>and</u> what the room is	Clean Daily	Emp Time	Comments
1	SE hall	x	38 min	2 bubblers, 4 door carpets
2	So. hall	x	29 min	2 door carpets
3	NE hall	x	38 min	2 bubblers, 4 door runners
4	Main hall stairs	x	15 min	Double wide staircase
5	South hall stairs	x	10 min	Typical stair case
6	Rm 12 Kindergarten	x	38 min	1 sink, carpet, 2 restrooms
7	Restroom	x	5 min	1 sink, 1 toilet
8	Restroom	x	8 min	1 sink, 1 toilet, 1 urinal
9	Main office complex		26 min	Includes principal office, conf. rm., carpet
10	Restroom	x	5 min	1 sink, 1 toilet
11	Work Room	x	6 min	
12	Library complex	x	42 min	All carpet
13	Librarian's office	x	6 min	All carpet
14	AV office	x	3 min	tile
15				

REMEMBER....DO NOT DEBATE
these times AT THIS MOMENT!!

- Please list each hall with its own time.
- Please list each staircase with its own time.
- Please list restrooms within classrooms separate.
- If you combine all offices within a room time, please note that as I do them separately.
Example: Library, Main Office, etc...

Recommended Cleaning Times

Hard Floors	Carpet	Gym/Hallway	Auto Scrubber	Damp Mop	Glass Cleaning	Blackboards	Bathrooms	Lunch Tables
(sq. footage)	(sq. footage)	(sq. footage)	(sq. footage)	(sq. footage)	(sq. footage)	(no. of bds.)	(no. of fixtures)	(no. of tables)
11min/1000	23min/1000	2min/1000	8min/1000	11min/1000	1min/50	2.5min/bd	3min/fixture	2min/table

Example: S.E. Hall—2500sq. Ft. / 1000 * 2 min = 5 min sweeping + bubbler(s)
(5 min to sweep + 6 min for bubblers = 11 min)

Example: S.E. Hall—2500sq. Ft. / 1000 * 8 min = 20 min scrubbing
(20 min + 11 min = 31 min total)

Example: CR—1120sq. Ft. / 1000 * 11 min = 12 minutes + sinks, boards, etc
(11 min sweeping + 2 min [20% damp mop] + 3 min sink + 1 min [2 boards, 5 min / 5 days] = 17 min)

Example: RR--10 fixtures * 3 min ea = 30 min cleaning



Time Study Worksheets

- Blank Time Study
- Started Time Study
- Filled in Time Study

Average Time Worksheet... Seems like you're duplicating data entry

Everyone's Time Averaged

K-Tec East										
	Room Number and what the room is	Length	Width	Square Feet	Cleaned Daily	Employee Time	Supervisor's Time	Spread Sheet Time	Average Time	Comments
1	H1W	23.5	7.5	176.25	x	12	15	21	17	7 fix, 1 mirror
2	Room 14	30.5	23	701.5	x	6	10	9	10	
3	Room 16 Lounge	23	23	529	x	10	12	13	12	2 sinks
4	Room 20 Kiln/storage	15	5	75	x	1	1	1	1	
5	Room 17 Art	8.5	3	25.5	x	12	20	16	19	2 sinks
6		29	23.5	681.5	x				0	door glass
7		6	4.5	27	x				0	
8	S4 (H2 - H1)	10	5	50	x	9	5	2	4	glass/carpet
9	Room 19 Phy Ed Office	10	4	40	x	5	1	1	1	
10	Room 15 SS/Lang Arts	23	29	667	x	8	12	9	11	glass
11	S3 (H2 - H1)	5.5	4.5	24.75	x	9	5	2	4	glass, 7 steps
12		3.5	4.5	15.75	x				0	
13	S2 (H2 - H1)	5.5	4.5	24.75	x	4	5	2	4	7 steps
70	Room 211	38.5	22.5	866.25	x	12	15	15	15	1 fix, glass
71	S4 (H3-H2)	14	10	140	x	5	10	2	7	20 steps
72	Room 210	39	22	858	x	12	15	15	15	1 fix, glass
73	Room 208	39	22	858	x	12	15	15	15	1 fix, glass
74	H3W	24	8	192	x	7	15	21	17	7 fix, glass
75	Room 212	24.5	12	294	x	3	5	4	5	glass
76	Room 206 (comp lab)	22	39	858	x	12	18	23	20	CARP, gl, 1 fix
77	H3M	23	8	184	x	8	20	27	22	9 fix, glass
78	Room 204	39	21	819	x	15	20	15	18	glass, fix
79	Room 202	39.5	22	869	x	12	12	6	10	1 fix, gl, carp
80	S1 (H3-H2)	14	10	140	x	5	5	3	4	20 steps
81	H3	13.5	200	2700	x	10	35	25	32	2 fix, gl
82				0	x				0	
83				0	x				0	
84				0	x				0	
				Total Minutes		605	806	744	718	
				Total Hours		10h5m	13h26m	12h24m	11h58m	

What it takes to clean daily

K-Tec East Building Information Work Sheet

Starting time (M-TH)	8am	Ending time	3pm
Starting time-Fri	8am	Ending time (early release)	2pm

HC— (5am-1:30p)			Total clean time: 150 mins prior to start of school
FT Cust— (1:30p-9:30p)	Loses 90 min due to his start time/school end time	Loses 40 min clean time: lunch/break	Total clean time: 350 min clean time (5hr 50min)
PT Cust— (3p-9p)	Loses 5 min due to school end time (students clear area)	Loses 20 min clean time: lunch/break	Total clean time: 335 min clean time (5hr 35min)

Questions:

- * What can be cleaned **after** the start of school?
(areas not high in demand: offices, custodial areas, etc...)
- * Can anything get done on an **as needed** basis?
(an area that doesn't get used every day: music room, stage, etc...)

The way the building is staffed right now:

150 clean minutes for HC (prior to start of school)

350 clean minutes for FT Cust (due to start time/breaks/school released)

335 clean minutes for PT Cust (start time/break)

835 total clean minutes (13hrs 55min)



Other Factors to Consider:

- Opening / Securing of the building
- Setups / teardowns
- Mechanical / Maintenance / Work Orders
- Breakfast Programs / Evening Activities
- Snow Removal
- Deliveries
- Customer Service / Day and Evening
- Multi-story buildings
- Elementary -vs- High School
- Types of Floor Surfaces in Rooms

Keep in Mind:

Not All Facilities Clean the Same

All of these items require time, time that is taken away from the cleaning duties of the staff. Each staff member will have different duties and times will vary depending on responsibilities.

Staff All Facilities According to the Following:

- Standard cleaning times
- Cleaning standard square footage (slide 13)
- Do not staff based on student population
 - We work off square footage, not student population
- **Use all available data to determine the most efficient staffing levels**

You did your time study now
what?

You did your time study now what?

Are you adequately staffed?

Staff Required for Adequate Cleaning Level



Cleanliness Level	Minimum Area *	Maximum Area *
Spotless Cleaning	10,000	11,000
Intensive Cleaning	18,000	20,000
Cleaning to ensure health & comfort for building users	28,000	31,000
Cleaning not generally acceptable for school environments	45,000	50,000
Cleaning considered unhealthy	85,000	90,000

* Measured in square feet

Remember: Primary and secondary building square footage per area will vary due to the needs at each learning level.

**** Primary Levels** will have higher cleaning times than secondary levels.

You did your time study now what?

Are you adequately staffed?

- If you found you are not adequately staffed - Next Steps.

You did your time study now what?

Are you adequately staffed?

If Yes, then what assessments you do you need to do to get the product you desire.

- Do you need to remap?
- Are staff following the correct route map?
- Are all staff following the same schedule (A/B, daily, weekly, etc.)
- Do staff need retraining?
- Staff Audits

You did your time study now what?

CLEANING GUIDELINES

Shop Areas

TASK	DAILY	WEEKLY	AS NEEDED
Empty waste baskets			
Sweep floors (work with shop teacher)			
Clean and sanitize sink			
Clean and sanitize dispensers			
Restock paper products			
Restock hand soap			
Change/report burned out lights			
Spot mop floor (wet mop)			
Clean chalkboard/whiteboard			

- **Daily** = All school days
- **Weekly** = One day per week
- **As Needed** = When used and/or requires cleaning
- **GRAFFITI MUST BE REMOVED IMMEDIATELY**

CLEANING GUIDELINES

Halls, Entrances and Grounds

TASK	DAILY	WEEKLY	AS NEEDED
Empty waste baskets			
Sweep floors (dust mop)			
Vacuum mats/runners			
Clean and sanitize sinks/fountains			
Spot clean glass			
Scrub floors (auto scrubber)			
Spot clean walls/locker fronts			
Change/report burned out lights			
Clean corners and edges			
Burnish floors			
EXTERIOR OF BUILDING			
Clean entrances			
Clean/pick up grounds			

- **Daily** = All school days
- **Weekly** = One day per week
- **As Needed** = When used and/or requires cleaning
- **GRAFFITI MUST BE REMOVED IMMEDIATELY**

CLEANING GUIDELINES

Restrooms and Locker Rooms

TASK	DAILY	WEEKLY	AS NEEDED
Empty waste baskets			
Empty sanitary napkin receptacles			
Clean and sanitize toilets			
Clean and sanitize sinks			
Clean and sanitize urinals			
Clean and sanitize floors (wet mop)			
Clean and sanitize dispensers			
Clean and sanitize showers			
Clean glass/mirrors			
Restock paper products			
Restock hand soap			
Spot clean walls			
Spot clean/dust lockers			
Spot clean partitions			
Change/report burned out lights			

- **Daily** = All school days
- **Weekly** = One day per week
- **As Needed** = When used and/or requires cleaning
- Carpet stains must be removed or reported immediately
- **GRAFFITI MUST BE REMOVED IMMEDIATELY**

You did your time study now what?

Identify right sized equipment



Scrub path: 26-34"
Solution/Rec. Tank: 35 gal
Run time: 7 hours
Coverage: 35,500 sq ft/hr



Scrub path: 17-28"
Solution/Rec. Tank: 17 gal
Run time: 3.5 hours
Coverage: 25,543 sq ft/hr



Supplement
the staff
with AI

CenoBots

AI-Powered Scrubber-dryer Robot



CenoBots L50

Today's Challenges

**Become more efficient
and streamlined**

What if there was a different way ³³
to get the data?



Finished Tasks

376

Finished Incomplete

0

2nd Shift

Garet Taylor
Garet Taylor

Last Task: North Campus East Gym
Under: 0/25

Started: 13:53
Finished: 21:27
Tasks: 25/25

Associate 1
Dave Bangle

Last Task: S404 South Campus Classr...
Under: 0/40

Started: 14:37
Finished: 23:01
Tasks: 40/41

Lead
Matt Sontag

Last Task: South Campus Fitness Center
Under: 0/61

Started: 13:32
Finished: 21:53
Tasks: 61/61

Associate 2
Ben Dawson

Last Task: S305 South Campus Lab A
Under: 0/15

Started: 14:37
Finished: 23:01
Tasks: 15/16

Associate 3
Mollie Fischer

Last Task: North Campus Lower Wom...
Under: 1/42

Started: 14:33
Finished: 22:31
Tasks: 42/42

Associate 4
Terra Hundt

Last Task: S113 South Campus Classr...
Under: 0/52

Started: 14:37
Finished: 23:01
Tasks: 52/54

Associate 6
Dave Lischka

Last Task: N129 North Campus Classr...
Under: 3/40

Started: 17:28
Finished: 19:40
Tasks: 40/40

Associate 7
Troy Meinecke

Last Task: S310 South Campus Classr...
Under: 0/50

Started: 14:38
Finished: 23:01
Tasks: 50/51

Associate 8
Kris Pieper

Last Task: North Campus West Gym ...
Under: 5/51

Started: 14:25
Finished: 22:33
Tasks: 51/51

Time per Task



Date: 10 Feb 2025

Time: 06:50:55

Active filters

Run as: *Bill King*
From: *1 Dec 2024*
To: *7 Feb 2025*
Company: *Arrowhead*
Task Type: *Room Detail Cleaning*
Roster: *2nd Shift*

Task Type	Associate	Total Completed Tasks	Average Time	Estimated Duration per Task
Room Detail Cleaning	Mollie Fischer	556	14 min 37 sec	
Room Detail Cleaning	Ben Dawson	121	15 min 31 sec	
Room Detail Cleaning	Dave Bangle	458	20 min 37 sec	
Room Detail Cleaning	Matt Kollath	430	11 min 26 sec	
Room Detail Cleaning	Terra Hundt	645	9 min 36 sec	
Room Detail Cleaning	Kris Pieper	653	9 min 15 sec	
Room Detail Cleaning	Garet Taylor	208	7 min 44 sec	
Room Detail Cleaning	Sterling Stangler	140	5 min 25 sec	
Room Detail Cleaning	Matt Sontag	241	8 min 51 sec	
Room Detail Cleaning	Kristy Torez	6	4 min 50 sec	
Room Detail Cleaning	Dave Lischka	104	10 min 28 sec	
Room Detail Cleaning	Troy Meinecke	377	11 min 50 sec	
Room Detail Cleaning - Overall Data	Overall Average	3939	11 min 51 sec	20 min 0 sec

Time per Task



Date: 10 Feb 2025

Time: 06:57:55

Active filters

Run as *Bill King*
From: *1 Dec 2024*
To: *7 Feb 2025*
Company: *Arrowhead*
Task Type: *Bathroom Detail Cleaning*
Roster: *2nd Shift*

Task Type	Associate	Total Completed Tasks	Average Time	Estimated Duration per Task
Bathroom Detail Cleaning	Matt Sontag	387	4 min 25 sec	
Bathroom Detail Cleaning	Dave Bangle	117	16 min 8 sec	
Bathroom Detail Cleaning	Matt Kollath	26	50 min 49 sec	
Bathroom Detail Cleaning	Mollie Fischer	15	8 min 25 sec	
Bathroom Detail Cleaning	Kris Pieper	34	35 min 2 sec	
Bathroom Detail Cleaning	Ben Dawson	4	28 min 53 sec	
Bathroom Detail Cleaning	Dave Lischka	51	30 min 33 sec	
Bathroom Detail Cleaning	Troy Meinecke	25	13 min 27 sec	
Bathroom Detail Cleaning	Garet Taylor	1	10 min 45 sec	
Bathroom Detail Cleaning - Overall Data	Overall Average	660	12 min 31 sec	20 min 0 sec

Time per Task



Date: 10 Feb 2025

Time: 06:56:08

Active filters

Run as: *Bill King*
From: *1 Dec 2024*
To: *7 Feb 2025*
Company: *Arrowhead*
Task Type: *Restroom Clean*
Roster: *2nd Shift*

Task Type	Associate	Total Completed Tasks	Average Time	Estimated Duration per Task
Restroom Clean	Garet Taylor	140	9 min 10 sec	
Restroom Clean	Kris Pieper	73	2 min 59 sec	
Restroom Clean	Sterling Stangler	12	8 min 7 sec	
Restroom Clean	Mollie Fischer	78	8 min 45 sec	
Restroom Clean	Terra Hundt	134	12 min 58 sec	
Restroom Clean	Ben Dawson	32	24 min 28 sec	
Restroom Clean	Matt Kollath	50	9 min 39 sec	
Restroom Clean	Dave Bangle	1	14 min 34 sec	
Restroom Clean	Matt Sontag	4	4 min 20 sec	
Restroom Clean	Troy Meinecke	9	7 min 0 sec	
Restroom Clean - Overall Data	Overall Average	533	10 min 5 sec	10 min 0 sec

More Data



[Terra's One Month Data](#)

On Going Staff Audit

Virtual
VMS

My - Designers - Organisation - Admin - Reports BILLK

Home 2.0 SmartCheck History Facility View My Tasks Site History Associate History Admin Dashboard Help

Facility: Arrowhead X
 Building: South Campus X
 Floor: South Campus 1st X
 Unit: X
 Room: X
 Shift: None 1st Shift 2nd Shift 3rd Shift

Inspection date from: X
 Inspection date to: X
 Auditor: X
 Employee: Terra Hundt X
 Supervisor: X
 Score range: From 0 To 100

[Print](#)

Task	Count	Score
Room QA	21	100.00

Auditor	Audit Name	Audit Type	Work Started	Work Finished	Passed	Failed	Percentage
> Matt Sontag	SmartCheck Audits	Room QA	Feb 5, 2025 5:51:47 PM	Feb 5, 2025 5:52:55 PM	1	0	100.00 %
> Matt Sontag	SmartCheck Audits	Room QA	Jan 29, 2025 6:03:20 PM	Jan 29, 2025 6:05:21 PM	1	0	100.00 %
> Matt Sontag	SmartCheck Audits	Room QA	Jan 22, 2025 5:40:22 PM	Jan 22, 2025 5:41:13 PM	1	0	100.00 %
> Matt Sontag	SmartCheck Audits	Room QA	Jan 14, 2025 10:07:10 ...	Jan 14, 2025 10:07:50 ...	1	0	100.00 %
> Matt Sontag	SmartCheck Audits	Room QA	Jan 8, 2025 5:59:22 PM	Jan 8, 2025 5:57:20 PM	1	0	100.00 %
> Matt Sontag	SmartCheck Audits	Room QA	Jan 2, 2025 9:49:09 PM	Jan 2, 2025 9:49:57 PM	1	0	100.00 %
> Matt Sontag	SmartCheck Audits	Room QA	Dec 18, 2024 5:31:59 PM	Dec 18, 2024 5:33:32 PM	1	0	100.00 %
> Matt Sontag	SmartCheck Audits	Room QA	Dec 13, 2024 9:12:24 PM	Dec 13, 2024 9:13:50 PM	1	0	100.00 %
> Matt Sontag	SmartCheck Audits	Room QA	Dec 3, 2024 9:15:39 PM	Dec 3, 2024 9:17:11 PM	1	0	100.00 %
> Matt Sontag	SmartCheck Audits	Room QA	Nov 20, 2024 9:25:42 PM	Nov 20, 2024 9:26:50 PM	1	0	100.00 %
> Matt Sontag	SmartCheck Audits	Room QA	Nov 13, 2024 5:59:32 PM	Nov 13, 2024 6:00:44 PM	1	0	100.00 %
> Ryan Dow	SmartCheck Audits	Room QA	Nov 6, 2024 9:03:02 PM	Nov 6, 2024 9:03:29 PM	1	0	100.00 %
> Matt Sontag	SmartCheck Audits	Room QA	Nov 5, 2024 8:07:29 PM	Nov 5, 2024 8:08:09 PM	1	0	100.00 %
> Matt Sontag	SmartCheck Audits	Room QA	Nov 1, 2024 10:06:29 PM	Nov 1, 2024 10:07:42 PM	1	0	100.00 %
> Matt Sontag	SmartCheck Audits	Room QA	Oct 22, 2024 5:59:42 PM	Oct 22, 2024 6:00:33 PM	1	0	100.00 %
> Matt Sontag	SmartCheck Audits	Room QA	Oct 14, 2024 8:08:53 PM	Oct 14, 2024 8:09:55 PM	1	0	100.00 %
> Matt Sontag	SmartCheck Audits	Room QA	Oct 8, 2024 6:03:55 PM	Oct 8, 2024 6:06:03 PM	1	0	100.00 %
> Matt Sontag	SmartCheck Audits	Room QA	Sep 30, 2024 10:01:08 ...	Sep 30, 2024 10:02:38 ...	1	0	100.00 %
> Matt Sontag	SmartCheck Audits	Room QA	Sep 25, 2024 6:00:13 PM	Sep 25, 2024 6:01:33 PM	1	0	100.00 %
> Matt Sontag	SmartCheck Audits	Room QA	Sep 18, 2024 5:10:31 PM	Sep 18, 2024 5:11:53 PM	1	0	100.00 %
> Bill King	SmartCheck Audits	Room QA	Sep 18, 2024 6:45:34 AM	Sep 18, 2024 6:46:48 AM	1	0	100.00 %

Questions?

THANK YOU

COMPANY NAME